

# Molded Series TF-2 Tideflex<sup>®</sup> Check Valve

- ▶ 100% elastomer construction
- ▶ Will not rust or corrode
- ▶ Will not warp or freeze open or shut
- ▶ Molded construction
- ▶ Low cracking pressure, low headloss
- ▶ Eliminates backflow

## Materials of Construction

- ▶ NEOPRENE, HYPALON<sup>®</sup>, BUNA-N, EPDM, VITON, CHLOROBUTYL, PURE GUM RUBBER, NSF-61 EPDM

## Mounting Bands

- ▶ 301 STAINLESS STEEL, 316 STAINLESS STEEL

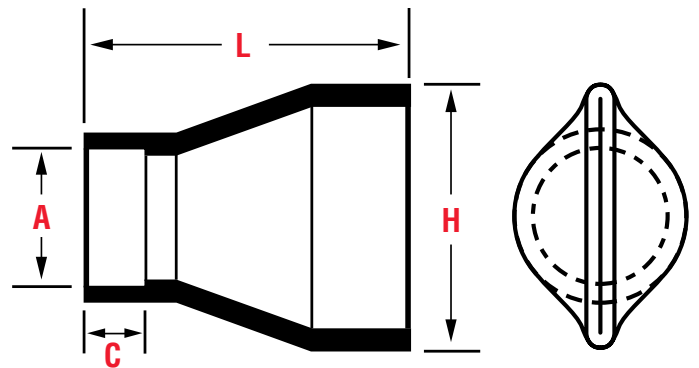

The Molded Tideflex<sup>®</sup> Check Valve is a revolutionary design for backflow prevention. It offers low cracking pressure to eliminate standing water and very low headloss that is not affected by rust, corrosion or lack of lubrication. Tideflex<sup>®</sup> Check Valves are cost-effective because they require no maintenance or repairs and have a long operational life span. Tideflex<sup>®</sup> operate using line pressure and backpressure to open and close so no outside energy source is required.

Tideflex<sup>®</sup> Valves are excellent replacements for ineffective metal flapgate valves because they will not warp or freeze and are virtually maintenance free.

The inside diameter of the Molded TF-2's cuff is constructed to exactly match the outside diameter of the pipe. The valve is slid onto the pipe and held in place with a stainless steel band clamp, eliminating flanging costs.

NOMINAL PIPE SIZE	PIPE O.D. (A)	LENGTH (L)	BILL HEIGHT (H)	CUFF LENGTH (C)
3/4"	1.05"	2.9"	2"	1"
1.25"	1.7"	5.9"	3.7"	1"
1.5"	1.9"	5.9"	3.7"	1.8"
2"	2.38"	5.9"	3.7"	1"
3"	3.5"	7.5"	5.9"	1.5"
4"	4.5"	10"	7"	2"
6"	6.63"	12"	10.1"	2"