

SL-50 Expansion Joint

- ▶ Single Arch
- ▶ Slips over pipe for easy connection
- ▶ Designed for low pressure systems
- ▶ Vibration and sound elimination
- ▶ Absorbs movement in pipeline
- ▶ No gaskets required
- ▶ Made in U.S.A.



The SL-50 Expansion Joint is designed to be quickly installed onto standard Schedule 40 pipe. The SL-50 uses slip-on connections with stainless steel mounting bands for a secure connection.

The SL-50 features an inner tube that is chosen to be compatible with the process material, a middle layer containing fabric and wire reinforcement, and an outer layer to protect the joint from occasional contact with oils, corrosion, and weathering.

The SL-50 can be constructed in custom lengths, with custom cuff I.D.'s, and in custom configurations.

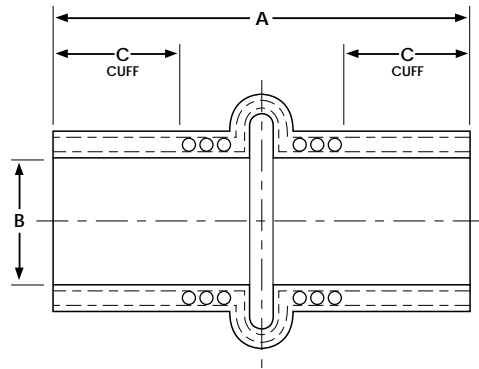

Materials of Construction

▶ ELASTOMERS

Pure Gum Rubber, Neoprene, Hypalon®, Chlorobutyl, Buna-N, EPDM, and Viton®

Dimensions SL-50/100 and SL-53

Size	B Actual I.D.	C Cuff	Length A			Compression		Extension		Deflection		Working Pressure psi
			SL-100	SL-50	SL-53	SL-50	SL-53	SL-50	SL-53	SL-50	SL-53	
*1"	1-5/16"	2"	6"	6"	9"	1"	3"	1/2"	1-1/2"	1/2"	1-1/2"	75
*1-1/2"	1-7/8"	2"	6"	6"	9"	1"	3"	1/2"	1-1/2"	1/2"	1-1/2"	75
*2"	2-3/8"	2"	6"	6"	9"	1"	3"	1/2"	1-1/2"	1/2"	1-1/2"	75
2-1/2"	2-7/8"	2"	6"	6"	9"	1"	3"	1/2"	1-1/2"	1/2"	1-1/2"	75
3"	3-1/2"	2"	6"	6"	9"	1"	3"	1/2"	1-1/2"	1/2"	1-1/2"	75
4"	4-1/2"	2"	6"	6"	9"	1"	3"	1/2"	1-1/2"	1/2"	1-1/2"	75
6"	6-5/8"	2"	6"	6"	10"	1"	3"	1/2"	1-1/2"	1/2"	1-1/2"	75
8"	8-5/8"	2"	6"	6"	10"	1"	3"	1/2"	1-1/2"	1/2"	1-1/2"	50
10"	10-3/4"	2"	6"	6"	10"	1"	3"	1/2"	1-1/2"	1/2"	1-1/2"	50
12"	12-3/4"	2"	6"	6"	10"	1"	3"	1/2"	1-1/2"	1/2"	1-1/2"	50
14"	14"	3"	10"	10"	14"	1"	3"	1/2"	1-1/2"	1/2"	1-1/2"	25
16"	16"	3"	10"	10"	14"	1"	3"	1/2"	1-1/2"	1/2"	1-1/2"	25
18"	18"	3"	10"	10"	14"	1"	3"	1/2"	1-1/2"	1/2"	1-1/2"	25
20"	20"	3"	10"	10"	14"	1"	3"	1/2"	1-1/2"	1/2"	1-1/2"	25
24"	24"	3"	10"	10"	14"	1"	3"	1/2"	1-1/2"	1/2"	1-1/2"	25
36"	36"	4"	12"	12"	16"	1"	3"	1/2"	1-1/2"	1/2"	1-1/2"	10
48"	48"	4"	12"	12"	16"	1"	3"	1/2"	1-1/2"	1/2"	1-1/2"	10
60"	60"	4"	12"	12"	16"	1"	3"	1/2"	1-1/2"	1/2"	1-1/2"	10
72"	72"	4"	12"	12"	16"	1"	3"	1/2"	1-1/2"	1/2"	1-1/2"	10

*Filled Arch Only