

Tideflex® Series 35 Flanged Duckbill Check Valve



- 100% elastomer construction
- Will not rust or corrode
- Will not warp or freeze open or shut
- Custom-built to customer specifications
- Low cracking pressure, low head loss
- Eliminates backflow

The Tideflex® Series 35 Flanged Check Valve is manufactured identically to the Series TF-2 Check Valve, with the addition of an integral elastomer flange. The standard flange size drilling conforms to ASME 16.5 and 16.47 Class 150 standards. All other domestic and international standards, as well as customer specified flange dimensions, are available. The Series 35 is furnished with 3/8" thick steel back-up rings for installation.

In some applications, a slip-over pipe check valve is not feasible because of an existing flange in the piping system or an existing flange cemented in the outfall piping system vault. In these cases, the Series 35 Check Valve is the solution.

The Series 35 is simple in design with only one part, the all-elastomer duckbill check valve. There are no seats or interference fits to corrode or freeze valve operation, making the Series 35 virtually maintenance free. The Series 35 seals completely around solids, making it ideal for fly ash, raw sewage, sludge, lime, mining slurries and many other abrasive and corrosive slurries.

Contact Red Valve for Series 35 backpressure ratings.

Materials of Construction

- **Elastomers:** Natural Rubber (NR), Ethylene Propylene Diene Terpolymer (EPDM)*, Acrylonitrile-Butadiene (NBR), Fluoroelastomer (FKM), Chloroprene (CR), Chlorosulfonated Polyethylene (CSM), Chloro-Isobutylene-Isoprene (CIIR), NSF/ANSI/CAN 61 and NSF/ANSI/CAN 372 certified EPDM
- **Retaining Rings:** 316 Stainless Steel, special alloys available

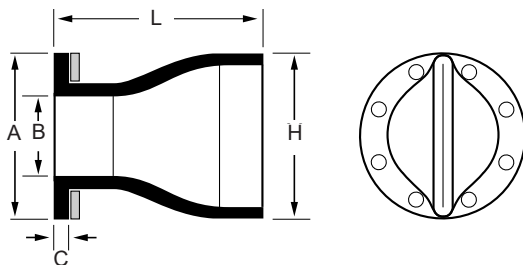

Series 35

ASME FLANGE SIZE	DIMENSIONS in/mm				
	FLANGE O.D. A	INSIDE DIAMETER B	FLANGE THICKNESS C	MAXIMUM LENGTH L	MAXIMUM HEIGHT H
0.5" 15mm	4.00 102	0.50 13	1.00 25	3.00 76	2.00 51
0.75" 20mm	4.00 102	0.75 19	1.00 25	3.00 76	2.00 51
1" 25mm	5.00 127	1.00 25	1.00 25	4.00 102	2.00 51
1.25" 32mm	5.00 127	1.25 32	1.00 25	7.00 178	4.00 102
1.5" 40mm	5.00 127	1.50 38	1.00 25	7.00 178	4.00 102
2" 50mm	6.00 152	2.00 51	1.00 25	6.00 152	4.00 102
2.5" 65mm	7.00 178	2.50 64	1.00 25	8.00 203	5.00 127
3" 80mm	8.00 203	3.00 76	1.00 25	10.00 254	6.00 152
4" 100mm	9.00 229	4.00 102	1.00 25	12.00 305	7.00 178
5" 125mm	10.00 254	5.00 127	1.00 25	17.00 432	9.00 229
6" 150mm	11.00 279	6.00 152	1.00 25	16.00 406	11.00 279
8" 200mm	14.00 356	8.00 203	1.00 25	17.00 432	13.00 330
10" 250mm	16.00 406	10.00 254	1.00 25	22.00 559	17.00 432
12" 300mm	19.00 483	12.00 305	1.00 25	27.00 686	20.00 508

ASME FLANGE SIZE	DIMENSIONS in/mm				
	FLANGE O.D. A	INSIDE DIAMETER B	FLANGE THICKNESS C	MAXIMUM LENGTH L	MAXIMUM HEIGHT H
14" 350mm	21.00 533	14.00 356	1.00 25	26.00 660	22.00 559
16" 400mm	24.00 610	15.25 387	1.00 25	28.00 711	27.00 686
18" 450mm	25.00 635	17.50 445	2.00 51	32.00 813	27.00 686
20" 500mm	28.00 711	19.25 489	2.00 51	35.00 889	33.00 838
22" 550mm	30.00 762	21.25 540	2.00 51	37.00 838	33.00 838
24" 600mm	32.00 813	24.00 610	2.00 51	43.00 1092	40.00 1016
30" 750mm	39.00 991	29.50 749	2.00 51	46.00 1168	49.00 1245
32" 800mm	42.00 1067	32.00 813	2.00 51	47.00 1194	54.00 1372
36" 900mm	46.00 1168	35.25 895	2.00 51	48.00 1219	62.00 1575
40" 1000mm	50.00 1270	40.00 1016	2.00 51	49.00 1245	62.00 1575
42" 1050mm	53.00 1346	42.00 1067	2.00 51	67.00 1702	74.00 1880
48" 1200mm	60.00 1524	48.00 1219	2.00 51	65.00 1651	80.00 2032
54" 1350mm	67.00 1702	54.00 1372	2.00 51	86.00 2184	100.00 2540
60" 1500mm	73.00 1854	60.00 1524	2.00 51	81.00 2057	101.00 2565
72" 1800mm	87.00 2210	72.00 1829	2.00 51	103.00 2616	121.00 3073