

Redflex Rubber Elbows and Fittings

- Withstands abrasion
- Connects misaligned piping
- Smooth port provides unrestricted flow
- Reduces noise and vibration
- Noncorrosive

Redflex® Rubber Elbows and Fittings are strong, durable and flexible. They reduce noise and vibration from pumps, compressors and other equipment.

Standard construction is an elastomer tube with fabric reinforcement and a synthetic cover for use with maximum continuous temperatures up to 180°F (82°C). For extra strength, spiraled steel wires are embedded in the body of the elbow from flange to flange. Redflex® Rubber Fittings have a 50 psi (350 kPa) standard working pressure, maximum of 75 psi (520 kPa), and can withstand 10" (254mm) Hg vacuum. They can also be manufactured for full vacuum upon request.

Materials of Construction

- **Elastomers:** Natural Rubber (NR), Ethylene Propylene Diene Terpolymer (EPDM)*, Acrylonitrile-Butadiene (NBR), Fluoroelastomer (FKM), Chloroprene (CR)*, Chlorosulfonated Polyethylene (CSM) Chloro-Isobutylene-Isoprene (CIIR)

* - White food grade options available



90° Elbow



90° Long Elbow



45° Elbow

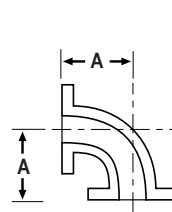

90° Standard Elbow

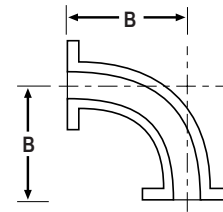

90° Long Radius Elbow

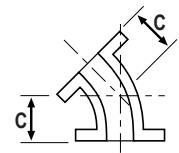

45° Elbow

Redflex Rubber Elbow Dimensions and Movement

SIZE I.D.	DIMENSIONS in/mm							
	FLANGE THICKNESS	FLANGE O.D.	CENTER TO FLANGE A 90° ELBOW	CENTER TO FLANGE B 90° LONG RAD.	CENTER TO FLANGE C 45° ELBOW	ALLOWABLE MOVEMENT		
						EXTENSION	COMPRESSION	DEFLECTION
2" 50mm	0.63 16	6.00 152	4.50 114	6.50 165	2.50 64	0.50 13	0.50 13	0.50 13
2.5" 65mm	0.63 16	7.00 178	5.00 127	7.00 178	3.00 76	0.50 13	0.50 13	0.50 13
3" 80mm	0.75 19	7.50 191	5.50 140	7.75 197	3.00 76	0.50 13	0.50 13	0.50 13
4" 100mm	0.75 19	9.00 229	6.50 165	9.00 229	4.00 102	0.50 13	0.50 13	0.50 13
5" 125mm	0.75 19	10.00 234	7.50 191	10.25 260	4.50 114	0.75 19	0.75 19	0.75 19
6" 150mm	0.75 19	11.00 279	8.00 203	11.50 292	5.00 127	0.75 19	0.75 19	0.75 19
8" 200mm	0.75 19	13.50 343	9.00 229	14.00 356	5.50 140	0.75 19	0.75 19	0.75 19
10" 250mm	0.75 19	16.00 406	11.00 279	16.50 419	6.50 165	0.75 19	0.75 19	0.75 19
12" 300mm	0.75 19	19.00 483	12.00 305	19.00 483	7.50 191	0.75 19	0.75 19	0.75 19
14" 350mm	0.75 19	21.00 533	14.00 356	22.50 572	7.50 191	0.75 19	0.75 19	0.75 19

Redflex Rubber Fittings



Tee



Cross



True Y

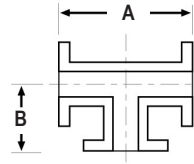

Tee

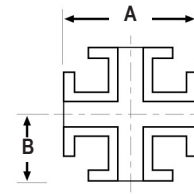

Cross

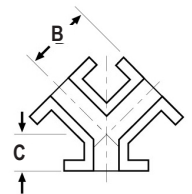

True Y

Redflex Rubber Fittings Dimensions and Movement

SIZE I.D.	DIMENSIONS in/mm							
	FLANGE THICKNESS	FLANGE O.D.	CENTER TO FLANGE A 90° ELBOW	CENTER TO FLANGE B 90° LONG RAD.	CENTER TO FLANGE C 45° ELBOW	ALLOWABLE MOVEMENT		
						EXTENSION	COMPRESSION	DEFLECTION
2" 50mm	0.63 16	6.00 152	9.00 229	4.50 114	2.50 64	0.50 13	0.50 13	0.50 13
2.5" 65mm	0.63 16	7.00 178	10.00 234	5.00 127	2.50 34	0.50 13	0.50 13	0.50 13
3" 80mm	0.75 19	7.50 191	11.00 279	5.50 140	3.00 76	0.50 13	0.50 13	0.50 13
4" 100mm	0.75 19	9.00 229	13.00 343	6.50 165	3.00 76	0.50 13	0.50 13	0.50 13
5" 125mm	0.75 19	10.00 234	15.00 381	7.50 191	3.50 89	0.75 19	0.75 19	0.75 19
6" 150mm	0.75 19	11.00 279	16.00 406	8.00 203	3.50 89	0.75 19	0.75 19	0.75 19
8" 200mm	0.75 19	13.50 343	18.00 457	9.00 229	4.50 114	0.75 19	0.75 19	0.75 19
10" 250mm	0.75 19	16.00 406	22.00 559	11.00 279	5.00 127	0.75 19	0.75 19	0.75 19
12" 300mm	0.75 19	19.00 483	24.00 610	12.00 305	5.50 140	0.75 19	0.75 19	0.75 19
14" 350mm	0.75 19	21.00 533	28.00 711	14.00 356	6.00 152	0.75 19	0.75 19	0.75 19