

Redflex J-1W Wide Arch Expansion Joint (JRE)



- Same face-to-face as the J-1
- Up to 3 times more movement
- Less force required to move
- Multiple wide arch available
- Made in the U.S.A.

Redflex J-1W Wide Arch Expansion Joints are engineered to permit greater movement capabilities than standard J-1 Expansion Joints. J-1W Expansion Joints can be used to alleviate more extreme expansion and compression stresses, without the need for double or triple arches, with the same face-to-face dimensions as the standard J-1 Single Arch Expansion Joint. The wide arch design also reduces the amount of force required to cause movement in the expansion joint while allowing the J-1W to be used under the same working pressures as the standard J-1. The J-1W's features and benefits result in cost savings for both new installations and replacement operations.

Materials of Construction

- **Elastomers:** Natural Rubber (NR), Ethylene Propylene Diene Terpolymer (EPDM)*, Acrylonitrile-Butadiene (NBR), Fluoroelastomer (FKM), Chloroprene (CR)*, Chlorosulfonated Polyethylene (CSM), Chloro-Isobutylene-Isoprene (CIIR)
- * - White food grade options available.

Vacuum Rating

- 15" (381mm) Hg
- Full vacuum available

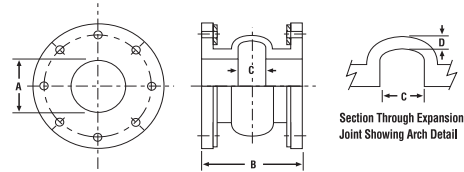

Redflex J-1W Wide Arch Expansion Joint Dimensions and Movement

DIMENSIONS in/mm										
SIZE A	B	C	D	AXIAL COMPRESSION in/mm	FORCE TO MOVE lbs/kg	AXIAL ELONGATION in/mm	FORCE TO MOVE lbs/kg	LATERAL DEFLECTION in/mm	FORCE TO MOVE lbs/kg	WORKING PRESSURE psi/kPa
*1"	6.00	2.00	1.00	1.75	144	0.75	106	0.75	245	165
25mm	152	51	25	44	65	19	48	19	111	1140
*1.25"	6.00	2.00	1.00	1.75	180	0.75	134	0.75	306	165
32mm	152	51	25	44	82	19	61	19	139	1140
*1.5"	6.00	2.00	1.00	1.75	216	0.75	161	0.75	367	165
40mm	152	51	25	44	98	19	73	19	166	1140
*2"	6.00	2.00	1.00	1.75	130	0.75	97	0.75	245	165
50mm	152	51	25	44	59	19	44	19	111	1140
2.5"	6.00	2.00	1.00	1.75	162	0.75	120	0.75	267	165
65mm	152	51	25	44	73	19	54	19	121	1140
3"	6.00	2.00	1.00	1.75	195	0.75	145	0.75	288	165
80mm	152	51	25	44	88	19	66	19	131	1140
4"	6.00	2.00	1.00	1.75	260	0.75	193	0.75	333	165
100mm	152	51	25	44	118	19	88	19	151	1140
5"	6.00	2.00	1.00	1.75	324	0.75	241	0.75	382	140
125mm	152	51	25	44	147	19	109	19	173	970
6"	6.00	2.00	1.00	1.75	389	0.75	289	1.00	432	140
150mm	152	51	25	44	176	19	131	25	196	970
8"	6.00	2.00	1.00	1.75	777	0.75	482	1.00	527	140
200mm	152	51	25	44	352	19	219	25	239	970
10"	8.00	2.00	1.00	1.75	850	0.75	603	1.00	566	140
250mm	203	51	25	44	386	19	274	25	257	970
12"	8.00	2.00	1.00	1.75	892	0.75	633	1.00	664	140
300mm	203	51	25	44	405	19	287	25	301	970
14"	8.00	3.00	1.25	2.00	1019	0.88	723	1.13	782	85
350mm	203	76	32	51	462	22	328	29	355	590
16"	8.00	3.00	1.25	2.00	1019	0.88	726	1.13	900	65
400mm	203	76	32	51	462	22	329	29	408	450
18"	8.00	3.00	1.25	2.00	1147	0.88	814	1.13	994	65
450mm	203	76	32	51	520	22	369	29	451	150
20"	8.00	3.00	1.25	2.00	1506	0.88	1054	1.13	1112	65
500mm	203	76	32	51	683	22	478	29	504	450
24"	10.00	3.00	1.25	2.00	1807	1.00	1265	1.13	1194	65
600mm	254	76	32	51	820	25	574	29	542	150
26"	10.00	3.00	1.25	2.00		1.00		1.13		55
650mm	254	76	32	51		25		29		380
28"	10.00	3.00	1.25	2.00		1.00		1.13		55
700mm	254	76	32	51		25		29		380
30"	10.00	3.00	1.25	2.00		1.00		1.13		55
750mm	254	76	32	51		25		29		380
36"	10.00	3.00	1.25	2.00		1.00		1.13		55
900mm	254	76	32	51		25		29		380
42"	12.00	3.00	1.25	2.00		1.00		1.13		55
1050mm	305	76	32	51		25		29		380
48"	12.00	3.00	1.25	2.00		1.00		1.13		55
1200mm	305	76	32	51		25		29		380
54"	12.00	3.00	1.25	2.00		1.00		1.13		55
1350mm	305	76	32	51		25		29		380

* Filled arch only.
 Consult factory for larger sizes.