

CTF - Tideflex® Series 35-1 Flanged Duckbill Check Valve



- Eccentric flat-bottom design
- Integral flange
- Lightweight, all-elastomer design
- Shorter length in sizes 42" and larger

Materials of Construction

- **Elastomers:** Natural Rubber (NR), Ethylene Propylene Diene Terpolymer (EPDM), Acrylonitrile-Butadiene (NBR), Fluoroelastomer (FKM), Chloroprene (CR), Chlorosulfonated Polyethylene (CSM), Chloro-Isobutylene Isoprene (CIIR), NSF/ANSI/CAN 61 and NSF/ANSI/CAN 372 certified EPDM
- **Retaining Rings:** 316 Stainless Steel, special alloys available

Series 35-1

ASME FLANGE SIZE	DIMENSIONS in/mm		
	FLANGE O.D. A	MAXIMUM LENGTH L	BILL HEIGHT H
4"	9.00	10.00	8.00
100mm	229	254	203
5"	9.00	10.00	8.00
125mm	229	254	203
6"	11.00	16.00	12.00
150mm	279	406	305
8"	13.50	18.00	16.00
200mm	343	457	406
10"	16.00	23.00	19.00
250mm	406	584	483
12"	19.00	26.00	23.00
300mm	483	660	584
14"	21.00	28.00	27.00
350mm	533	711	686
16"	23.50	36.00	30.00
400mm	597	914	762
18"	25.00	38.00	34.00
450mm	635	965	864
20"	27.50	45.00	37.00
500mm	699	1143	946
24"	32.00	49.00	44.00
600mm	813	1245	1118
30"	38.75	58.00	56.00
750mm	984	1473	1422
32"	41.75	66.00	60.00
800mm	1060	1676	1524
36"	46.00	67.00	70.00
900mm	1168	1702	1778
40"	46.00	67.00	70.00
1000mm	1168	1702	1778
42"	53.00	66.00	74.00
1050mm	1346	1676	1880
48"	59.50	71.00	81.00
1200mm	1511	1803	2057
54"	66.25	77.00	90.00
1350mm	1683	1956	2286

The Tideflex® Series 35-1 Check Valve features a flat-bottom design and an integral elastomer flange, which allows mounting to flanged outfall pipes or directly to headwalls with flush piping.

The flange size drilling conforms to ASME B16.10 Class 150, or can be constructed with DIN 2632 and other standards. The Series 35-1 Check Valve is furnished complete with retaining rings for installation.

The Series 35-1 is often a replacement for flanged flapgates. Hinge pins in flapgates rust and corrode if they are not routinely lubricated, causing the flapper to hang open and allow backflow. Small debris that collects in the seating area of the valve will also keep the flapper open. The Series 35-1 has no moving parts that can corrode, warp or freeze. The 35-1 also seals around entrapped solids and debris.

Tideflex® Series 35-1 Valves in sizes 18" and larger are constructed with a curved bill as standard. Contact Red Valve for Series 35-1 backpressure ratings.

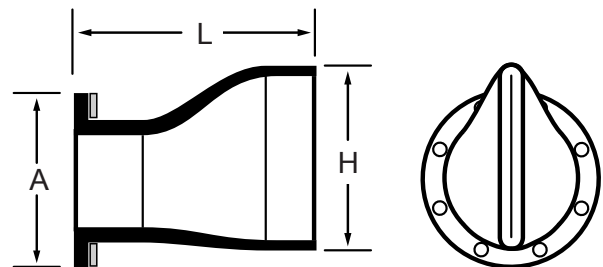

ASME FLANGE SIZE	DIMENSIONS in/mm		
	FLANGE O.D. A	MAXIMUM LENGTH L	BILL HEIGHT H
60"	73.00	78.00	94.00
1500mm	1854	1981	2388
70"	85.00	102.00	121.00
mm	2159	2591	3073
84"	100.00	111.00	120.00
mm	2540	2819	3048
90"	107.00	103.00	144.00
mm	2718	2616	3658
102"	98.00	114.00	169.00
mm	2489	2896	4293

Dimensions are subject to change due to customized construction.