

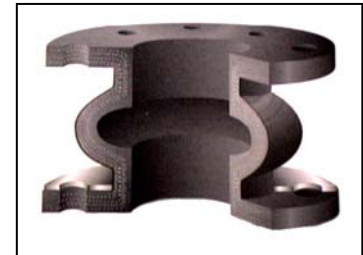

# Redflex J-1 Schwingungsdämpfer/ Rohrkompensator

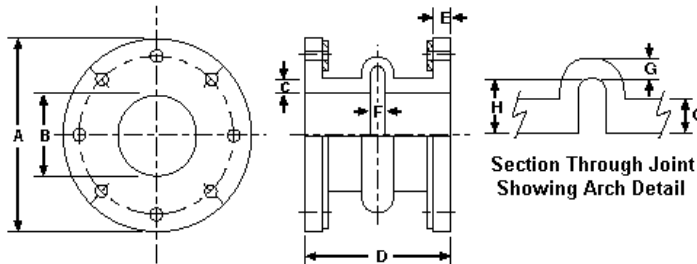

**Achtung:** Abmessungen und Gewichte beziehen sich auf die Standard-Version..  
Optionen und Zubehör können die Größe und / oder das Gewicht beeinflussen



Size	A	B	C	Single Arch D	Double Arch D	Triple Arch D	E	F	G	H	Approx. Weight (lbs)
* 1"	4 1/4"	1"	5/8"	6"	10"	12"	9/16"	1/2"	7/16"	1 1/8"	2
* 1 1/4"	4 5/8"	1 1/4"	5/8"	6"	10"	12"	9/16"	1/2"	7/16"	1 1/8"	2 1/2
* 1 1/2"	5"	1 1/2"	5/8"	6"	10"	12"	9/16"	1/2"	7/16"	1 1/8"	3
2"	6"	2"	3/4"	6"	10"	12"	9/16"	1/2"	1/2"	1 1/4"	4
2 1/2"	7"	2 1/2"	3/4"	6"	10"	12"	9/16"	1/2"	1/2"	1 1/4"	4 1/2
3"	7 1/2"	3"	3/4"	6"	10"	12"	9/16"	1/2"	1/2"	1 1/4"	5 1/4
4"	9"	4"	7/8"	6"	10"	12"	9/16"	1/2"	1/2"	1 1/4"	7
5"	10"	5"	7/8"	6"	10"	12"	9/16"	1/2"	1/2"	1 1/4"	8 1/4
6"	11"	6"	7/8"	6"	10"	12"	5/8"	1/2"	1/2"	1 1/4"	9 3/4
8"	13 1/2"	8"	7/8"	6"	10"	14"	3/4"	3/4"	5/8"	1 1/2"	15
10"	16"	10"	1"	8"	12"	14"	3/4"	3/4"	11/16"	1 1/2"	21
12"	19"	12"	1 3/16"	8"	12"	14"	3/4"	3/4"	11/16"	1 1/2"	28
14"	21"	14"	1 3/16"	8"	12"	16"	7/8"	3/4"	3/4"	2"	39
16"	23 1/2"	16"	1 3/16"	8"	12"	16"	7/8"	3/4"	3/4"	2"	45 1/2
18"	25"	18"	1 3/16"	8"	12"	16"	7/8"	3/4"	3/4"	2"	50 1/2
20"	27 1/2"	20"	1 1/4"	8"	12"	16"	1"	7/8"	3/4"	2"	61
24"	32"	24"	1 3/8"	10"	14"	18"	1"	7/8"	3/4"	2"	75
26"	34 1/4"	26"	1 3/8"	10"	14"	18"	1"	1"	3/4"	2 1/4"	85 1/2
28"	36 1/2"	28"	1 3/8"	10"	14"	18"	1"	1"	3/4"	2 1/4"	93
30"	38 3/4"	30"	1 3/8"	10"	14"	18"	1"	1"	3/4"	2 1/4"	101 1/2
36"	46"	36"	1 1/2"	10"	14"	18"	1"	1"	3/4"	2 1/4"	137 1/2
42"	53"	42"	1 1/2"	12"	14"	20"	1 3/16"	1 1/8"	7/8"	2 1/2"	182 1/2
48"	59 1/2"	48"	1 1/2"	12"	14"	20"	1 3/16"	1 1/8"	7/8"	2 1/2"	211
54"	66 1/4"	54"	1 1/2"	12"	14"	20"	1 3/16"	1 1/8"	7/8"	2 1/2"	265 1/2
60"	73"	60"	1 1/2"	12"	14"	20"	1 3/16"	1 1/8"	7/8"	2 1/2"	309
72"	86 1/2"	72"	1 1/2"	12"	14"	20"	1 3/16"	1 1/8"	7/8"	2 1/2"	385
78"	93"	78"	1 1/2"	12"	14"	20"	1 3/16"	1 1/8"	7/8"	2 1/2"	410
84"	99 3/4"	84"	1 1/2"	12"	14"	20"	1 3/16"	1 1/8"	7/8"	2 1/2"	480

- nur mit Massiv- Dämpfungsbogen („Filled Arch“) lieferbar.
- Größere Nennweiten mit „Filled Arch“ lieferbar; zulässige Ausdehnung reduziert sich auf den halben Wert !